

SECURA®

CITRUS JUICER

USER MANUAL

MODEL: GS-405Y

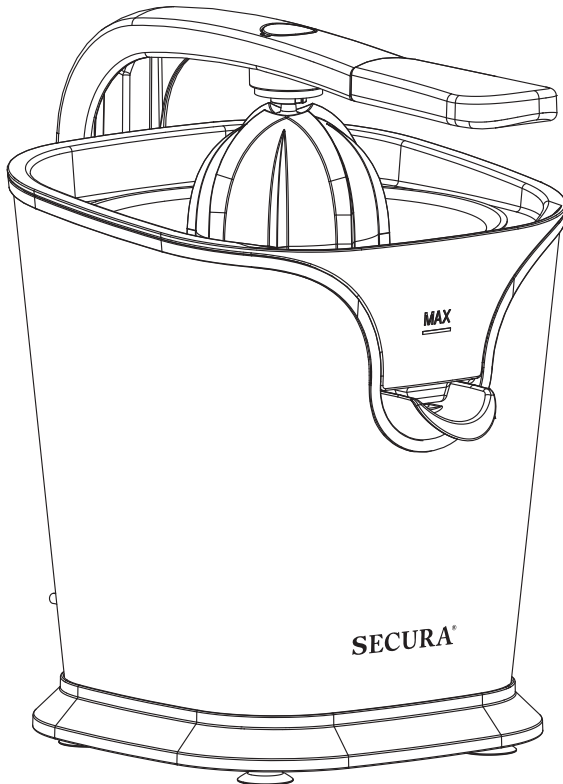

www.thesecura.com

WELCOME

Congratulations on your new purchase from Secura!

We believe in providing the best products to our customers, and all Secura products meet strict standards for manufacturing, performance, and safety. We believe in providing the best customer service, and that is why we offer a two year warranty that will ensure customer satisfaction. You can expect to continue enjoying your new Citrus Juicer for many years.

SECURA®

Copyright © 2017 – Secura Inc. - All rights are reserved.

The material in this publication is protected under International and Federal Copyright Laws and Treaties, and as such, any unauthorized reprint or use of this material is strictly prohibited.

No part of this book may be reproduced or transmitted in any form without the written permission of the author, except for the inclusion of brief quotations in a review.

Reproduction or translation of any part of this work without the permission of the copyright holder is against the law.

IMPORTANT SAFEGUARDS

Read all instructions and save for future reference.

- Remove any stickers before using the citrus juicer.
- To protect against risk of electrical shock, do not put cord, plugs or appliance in water or other liquid.
- Fully unwind the power cord before use.
- Always make sure the citrus juicer is properly assembled before plugging in and using.
- Close supervision is necessary when any appliance is used by or near children.
- Unplug from outlet when not in use, before putting on or taking off parts, or before cleaning.
- Avoid contacting moving parts.
- Do not operate any appliance with a damaged cord or plug or after the appliance malfunctions, or is dropped or damaged in any manner. Contact the customer service number listed in this manual.
- The use of attachments is not recommended and may cause fire, electric shock or injury.
- Do not use outdoors.
- Do not let cord hang over edge of table or counter.
- Do not let cord touch hot surfaces or become knotted.
- Do not let cord contact hot surface, including the stove.
- Use caution when operating the appliance – do not place hands or fingers near moving or rotating parts.
- Do not use this appliance for other than intended use.
- Keep the appliance clean; refer to care and cleaning section of this manual.
- This appliance is not intended for use by persons (including children) with reduced physical, sensory or mental capabilities, or lack of experience and knowledge, unless they have been given supervision or instruction concerning use of the appliance by a person responsible for their safety.. Please Read and Save this Use and Care Book.

SAVE THESE INSTRUCTIONS
Household use only, not for commercial use.

PARTS LIST

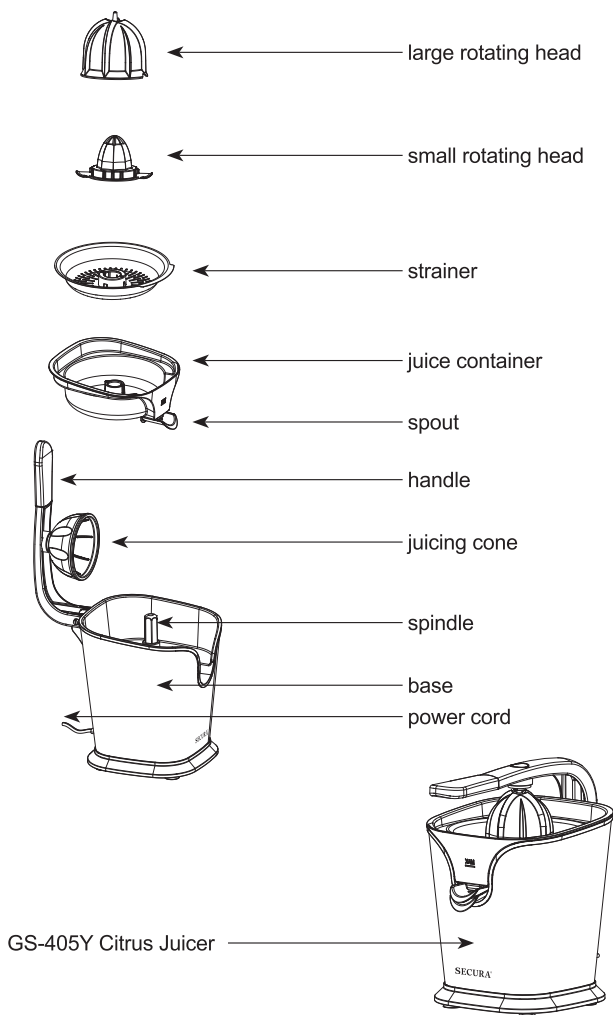

BEFORE FIRST USE

1. Danger: Keep all packaging material away from children, there is a suffocation hazard.
2. Remove any stickers before using the juicer for the first time and save any packaging material in the event the product must be returned for service.
3. Examine the juicer for visible damage and check that all of the parts are present.
4. Wash all removable parts before using it for the first time as instructed in the "Cleaning" section of this manual.
5. Wipe the motor base with a damp cloth.

OPERATION

1. Place the appliance on an even surface that is easy to clean.
2. Connect the power plug to an AC120V, 60Hz electrical outlet.
3. Choose the large or the small rotating head, depending on the type of fruit you are juicing.
4. The large rotating head is suitable for juicing larger citrus fruit, such as grapefruits or oranges.
5. The small rotating head is suitable for juicing small citrus fruit, such as lemons or limes.
6. If you wish to use the large rotating head, fit the small rotating head onto the drive shaft, and then place the large rotating head over the top of the small rotating head.
7. To separate the rotating heads, pull the large rotating head up and off.

Juicing:

Caution: if you apply too much pressure to the juicing rotating head, the motor may stop or seize.

1. Fit the appropriate rotating head onto the drive shaft.
 - a). If you wish to collect the juice in the container, press the spout upwards to close it (it will "snap" into place). A maximum of 12 oz. of juice can be held in the juice container.
 - b). If you want the juice to run straight into a cup, press the spout downwards to open it and then place a cup directly under the spout.
2. Plug the Juicer power cord into an easily accessible electrical socket.
3. Cut a citrus fruit in half and press the cut end of one fruit half onto the rotating head. The juicer switches on automatically when you press the handle down and the rotating head starts to turn. The juicer automatically switches off as soon as you reduce pressure on the rotating head. The rotating head scrapes the pulp out and squeezes the juice from the fruit. The juice flows through the strainer into the juice container from where it can either accumulate in the container or run directly into a cup. The strainer keeps back thick pulp and seeds.
4. To maximize the quantity of juice extracted from a fruit, press the fruit onto the rotating head several times.

AFTER USE

1. Unplug the appliance.
2. Remove the rotating heads, strainer, juice container and drive shaft from the appliance and clean them as described in the "Cleaning" section of this manual.

JUICING ADVICE

1. Citrus fruit juices should be consumed immediately and never stored in a metal container.
2. Citrus juices are ideal for mixing. For example, you can mix orange juice with lemon juice for extra vitamin C.
3. Freshly squeezed juice gives cocktails a particularly tangy twist and better flavor. Lemon juice is also delicious in hot tea and additionally helps you build up your defenses when you have a cold.

CLEANING

1. Always unplug the unit before cleaning or when not in use.
2. Pull up on rotating heads to remove from strainer.
3. Remove the strainer from the pulp container.
4. Lift pulp container off of spindle.
5. Rinse the strainer, pulp container and rotating heads immediately after each use. Use a bristle brush to remove fine pulp that may remain.
6. Use dish soap and warm water to wash all removable parts or place in the dishwasher, top rack only.
7. Wipe the base with a damp cloth or sponge. Do not immerse in water or place in the dishwasher.

TROUBLE SHOOTING

1. Motor won't start - Is the juicers power cord connected properly to the power outlet?
2. Motor stops running while juicing – Do not apply too much pressure to the handle while juicing.
3. Although the spout is closed, juice still drips out – Check to make sure bits of pulp are not keeping the spout from closing properly.

TECHNICAL INFORMATION

Rated Voltage	120V 60HZ
Rated current	8.3A
Rated power input	160W
Juice container capacity:	12 oz

DISPOSAL



When the appliance has reached the end of its life, please be responsible with its disposal. This and other electrical appliances contain valuable material and can be dangerous to the environment if not disposed of properly. We ask that you follow the rules and regulations of your town as far as disposing of electric appliances. Please endeavor to take the appliance to an authorized recycling facility near you.

CONTACT

If you have any problems with this unit, please contact at (888) 792-2360 or email us at CustomerCare@thesecura.com.

Please read operating instructions before using this product.

Please keep the original box and packaging materials in the event that service is required.

SECURA®

Manufacturer's Limited Warranty

The Manufacturer of the product warrants to the original purchaser of this product from an authorized reseller or distributor that this product will be free from defects in material and workmanship under normal use and service for 2 years after date of purchase. Manufacturer will, at its option, repair or replace with new or refurbished product. The manufacturer reserves the right, before having any obligation under this limited warranty, to inspect the damaged product, and all costs of shipping the damaged product for inspection and warranty service shall be borne solely by the purchaser.

The manufacturer's limited warranty is valid only in accordance with the following conditions:

1. The product is purchased directly from manufacturer or an authorized reseller.
The warranty is not transferable, only the original purchaser is covered by this warranty.
2. This warranty is void if the product is used in a commercial or institutional establishment.
3. This warranty is void if the product has been subject to misuse, abuse, negligence, unauthorized modification or repair, or accident. Normal wear and tear are not covered by this warranty.
4. Purchaser must present acceptable proof of original receipt for the product.
5. This warranty does not affect any other legal rights you may have by operation of law.

Secura Inc.
CustomerCare@thesecura.com
Brookfield, Wisconsin. USA

SECURA®

Secura Inc.

Tel: 888-792-2360

CustomerCare@thesecura.com

www.thesecura.com

Brookfield, Wisconsin. USA

For warranty claims, please visit our website **www.thesecura.com**
to submit a warranty claim and provide proof of purchase