



SECURA COFFEE & SPICE GRINDER

Model# SP-7415





Copyright © 2010 – Secura Inc. - All rights are reserved.

The material in this publication is protected under International and Federal Copyright Laws and Treaties, and as such, any unauthorized reprint or use of this material is strictly prohibited.

No part of this book may be reproduced or transmitted in any form without the written permission of the author, except for the inclusion of brief quotations in a review.

Reproduction or translation of any part of this work without the permission of the copyright holder is against the law.

SECURA COFFEE & SPICE GRINDER

Contents

- 1 Copyright Notice
- 2 Table of Contents
- 3 Safety Precautions
- 4 Grinder Parts
- 4 Before Use
- 5 Usage Instructions
- 6 Coffee Beans
- 6 Spices
- 7 Note
- 7 Appliance Care
- 8 Manufacturer's Limited Warranty

This Grinder is for Household Use Only
Save Instructions for Later Reference

SECURA COFFEE & SPICE GRINDER

Safety Precautions

Anytime you will be using an electrical appliance of any type, safety precautions should be considered and followed at all times. This includes the precautions below:

1. Before using your new appliance, read all instructions and safety precautions.
2. Never immerse the appliance, cord, or plug in water and do not place the appliance in the dishwasher.
3. Always supervise children in the area of the appliance and do not allow children to operate it.
4. When the appliance is not in use, unplug it from the outlet. Unplug the appliance to clean, remove parts, or put on parts.
5. If the appliance has a damaged cord or plug, DO NOT operate it. This could result in damage, electric shock, fire, or other physical injury.
6. Never use parts or accessories not made for the appliance.
7. This appliance is not for outdoor use.
8. Use safety with the cord. It should not be allowed to lay on a hot surface, and it should not be left hanging from a counter, shelf, or table.
9. Never use the appliance in any manner other than its intended use.
10. Do not place the appliance near or on a heated oven, an electric or gas burner, or any other hot surface.
11. When disconnecting the appliance, turn the power off and remove plug from wall outlet by grasping the plug itself. Do not yank out by the cord.
12. To extend the grinder's lifespan and avoid motor damage, do not use for more than 30 seconds continuously. Most grinding tasks can be done within seconds.
13. Do not put hands or kitchen implements near or in contact with moving parts.
14. Always check to ensure the grinder is clean and free of moving parts before each use.

Polarized Plug

Your new coffee grinder includes a polarized plug. This means one prong of the plug is larger than the other. This helps to reduce the risk of fire, electric shock, and physical injury as the plug will only fit into the outlet in the proper manner. When plugging in the appliance, if the plug does not fit, do not force it into place. Instead, reverse the plug and try again. Do not attempt to modify the plug or the power outlet. If the plug does not fit after reversing, contact a licensed electrician.

SECURA COFFEE & SPICE GRINDER

Grinder Parts

1. Lid
2. Chamber for Grinding
3. Power Button
4. Cord

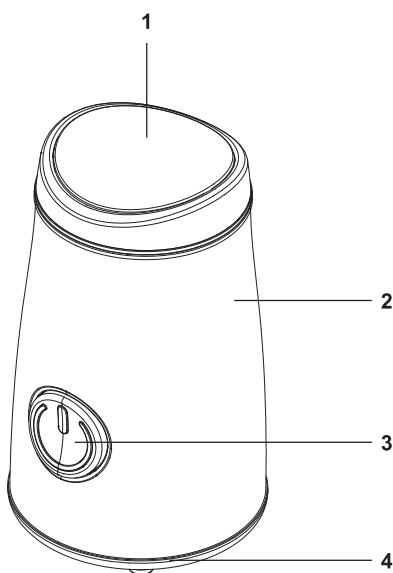

Before Use

After unpacking the grinder, be sure to remove all packing materials and clean the grinder thoroughly. This should include cleaning the inside chamber, the lid, and the exterior of the grinder. Use a soft cloth that is damp. Do not use harsh abrasives or scrubbing materials as they will damage the grinder. Be sure that the grinder is thoroughly clean then use a soft cloth to dry it. When cleaning the inside of the chamber, do so with care. The grinding blade is sharp and could cause injury.

SECURA COFFEE & SPICE GRINDER

Usage Instructions

1. After cleaning the grinder thoroughly, remove the lid.
2. Pour material to be ground (coffee beans or spices) into the chamber. Do not overfill. The grinder can manage up to 1.8 ounces at a time. Overfilling could damage the grinder.
3. Place lid on the grinder. Turn the lid clockwise to lock it into place. Plug the grinder into a working power outlet.
4. Place a hand on the top of the grinder to steady it and then press and hold the on/off button. If the lid of the grinder is not properly placed, it will not function. If the grinder does not start when the power button is on, check to ensure the lid is in place then try again.
5. When the material is ground accordingly, release the on/off button. In order to lengthen the life of the grinder, do not run it for longer than 30 seconds, use it in short bursts until the material is ground to your preference. In order to ensure that you get to enjoy your coffee grinder for a long time, it should never be turned on for more than 30 seconds continuously. Between each 30 seconds run, the grinder should stay off for at least one minute. The grinder has built-in overheat protection mechanism. It shuts down the grinder whenever the temperature reaches the critical point to protect the motor. Please let it cool before using it again.
6. Once the grinder is turned off and the blades have come to a full stop, remove the lid and empty the chamber.

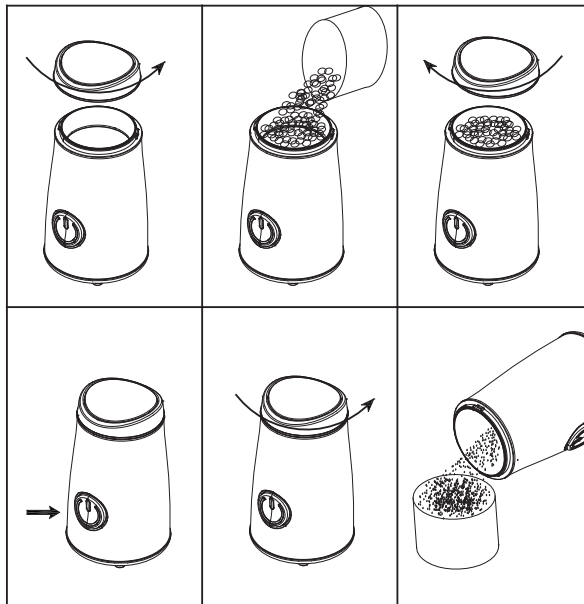

SECURA COFFEE & SPICE GRINDER

Coffee Beans

The main purpose of this coffee grinder is to provide freshly ground coffee. The grinder is able to manage 1.8 ounces of beans in one grind session. That equals approximately a round of 10 cups of coffee at one time.

You will need to spend some time determining what type of grind you like for your coffee. For reference, finely ground coffee exposes more surface to water and the flavor is extracted from the grind more rapidly. Coarser ground coffee exposes less surface to water and the flavor is not removed so quickly. Some coffee makers have specific rules about what grind to use with them. Be sure to consult the instruction manual for your coffee maker before use.

In order to keep coffee fresh, robust, and rich, do not grind more beans than you need at one time. This will keep the grind from growing stale and less flavorful. A large pot coffee maker may require up to two grinds.

Coffee beans keep best when stored in a dark airtight container in the freezer. They will last up to two months when kept frozen. You may grind the beans directly from the freezer without damage.

Spices

Your coffee grinder can also be used to create flavorful and fresh ground herbs and spices. You can create your own spiced flavor by combining and grinding various herbs. Some of the spices that will grind the best include peppercorns, allspice, coriander, mustard seed, and celery seed. Freshly ground spices taste much different from prepackaged and sealed items.

SECURA COFFEE & SPICE GRINDER

Note

Your grinder should not be used on certain materials that are moist, water filled, or gummy. This could damage the grinder and blades. This means such materials as chocolate and candied ginger should not be put in the grinder. Additionally, extremely hard items like nuts can damage the grinder. The coffee grinder is not designed to make any type of paste and trying to do so will damage it. Oily spices like cinnamon and cloves can discolor the lid; hard items like grains, rice, and rye can pit and crack the lid, cause other damages and should be avoided.

Appliance Care

- Before cleaning, always unplug the grinder from the wall.
- Use a soft, damp cloth to wipe down the cover and grinding chamber. Use care when wiping down the blades as they are very sharp. A small, soft bristled brush can be used in order to remove particles that have become stuck in the grinder.
- DO NOT place any part of the coffee grinder in the dishwasher and do not immerse any part of it in water.
- Use a soft, damp cloth to clean the exterior of the grinder.
- In order to continue producing the best and most flavorful grinds, always clean the grinder between uses. This will avoid crossing flavors in the chamber.
- When grounds get lodged under the blades, empty the chamber and turn on the grinder for 1-2 seconds. This will help to get any particles dislodged for easier cleaning.
- If odors are not easily cleaned from the chamber, place baking soda within it, seal the lid and let the grinder sit overnight. When the baking soda is removed, the grinder should be free of odors.



Manufacturer's Limited Warranty

The Manufacturer of the product warrants to the original purchaser of this product from an authorized reseller or distributor that this product will be free from defects in material and workmanship under normal use and service for 1 year after date of purchase. Manufacturer will, at its option, repair or replace with new or refurbished product. The manufacturer reserves the right, before having any obligation under this limited warranty, to inspect the damaged product, and all costs of shipping the damaged product for inspection and warranty service shall be borne solely by the purchaser.

The manufacturer's limited warranty is valid only in accordance with the following conditions:

1. The product is purchased directly from manufacturer or an authorized reseller. The warranty is not transferable, only the original purchaser is covered by this warranty.
2. This warranty is void when the product is used in a commercial or institutional use.
3. This warranty is void if the product has been subject to misuse, abuse, negligence, unauthorized modification or repair, or accident. Normal wear and tear are not covered by this warranty.
4. Purchaser must present acceptable proof of original receipt for the product.
5. This warranty does not affect any other legal rights you may have by operation of law.

Manufactured by
Secura Inc.
Brookfield, Wisconsin, USA
CustomerCare@thesecura.com



Manufactured by Secura Inc.
Brookfield, Wisconsin, USA

Tel: 888-792-2360
Fax: 866-941-6918
CustomerCare@thesecura.com

www.thesecura.com

For warranty claims, please visit our website **www.thesecura.com**
to submit a warranty claim and provide proof of purchase